

Light data

Luminous flux
590 lm (total)
515 lm (useful)

Tunable white
2,200–4,000 K

Beam angle
40°

Dimming
0.1–100 %

Ra
90

SDCM
3

L70/B50
60,000 h

Light source
LED (non user
replaceable)

Technical data

IP rating
Luminaire: IP44
Driver: IP20

Protection
Overtemperature
protection

Protection class
Class II

Permissible ambient
temperature
-25 to +35 °C

Maximum power
consumption
8 W

Energy
efficiency class
F

Mains electricity
230 V~ 50 Hz

Standby power
Pno, Psb: N/A
Pnet: 0.09 W

Maximum bypass
current
16 A

Cable area
0.75–2.5 mm²

Insulation
DWN-01: Ta 25°C
installed directly against
insulation.

Ta 35°C ceilings without
insulation.

DWN-02: Ta 35°C
installed directly against
insulation.

Operating environment
Indoor/outdoor
(e.g eaves)

Radio
2.4 GHz mesh
Bluetooth® <10 dBm

Radio range:
approx. 10 m indoors.

The Plejd mesh
technology extends the
range by allowing the
units to communicate
with each other.

RISK OF INJURY TO PERSON OR PROPERTY

All work on the appliance must be carried out
by an authorized electrician. National laws and
regulations must be followed.

Compliant to standards

Hereby, Plejd AB declares that the radio
equipment type DWN-01 & DWN-02 is in
compliance with Directive 2014/53/EU.

The full text of the EU declaration of conformity
and third party licenses are available at the
following internet address: plejd.com/compliance

Support

In the event of any technical questions,
please contact our customer service:
support@plejd.com | +46 (0) 10 203 89 91

Plejd AB, Krokslätts Fabriker 27A
431 37 Mölndal, Sweden



Important information

Do not use the product if it has visible signs
of damage.

The light source must only be replaced by the
manufacturer or qualified service agent. If the
external flexible cable of this luminaire is damaged,
the luminaire shall be destroyed.



Disposal and recycling

This electrical product should not be disposed of
together with other household waste. Contact your
local recycling center for guidance on electrical and
electronic equipment disposal.

EN

Plejd

DWN-01 & DWN-02

INSTALLATION MANUAL

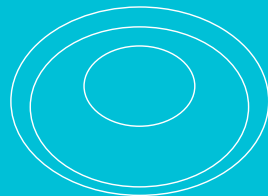

Further information can be found
in the **Plejd** app or at plejd.com

NOTE! Do not wire to dimmer.

Dimmer is built-in.



Mount in a
Ø 83 mm hole.

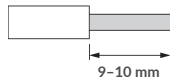

Use protective box to improve
IP rating inside recess.

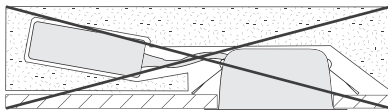
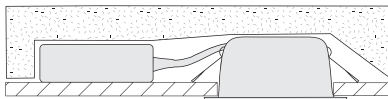
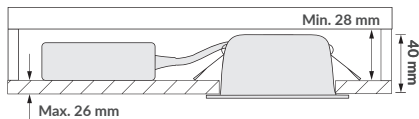
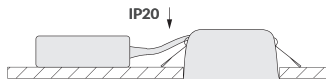
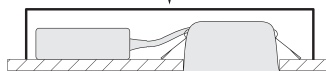

Insulation

Turn off the power before installation.

Install the product

Step 1. Open the driver by pressing the blue button with a narrow tool.

Step 2. Pull the sleeve towards the light source.

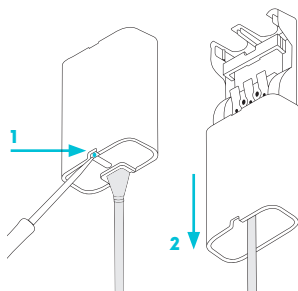

Step 3. Connect live (L) and neutral (N) wires. Control input 1 can be used for control with: push button (preset), light switch, or motion sensor (with neutral conductor). The input can also be used to wirelessly control one or more products from Plejd.

NOTE! Do not connect input 1 between several products. Use the app to configure the control and connection of several luminaires in a group.

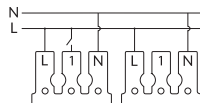

Luminaire 1 Luminaire 2

Step 4. Connect with double-insulated cable or 16 mm flexible conduit. If mounted with cable, press the strain bar firmly into place. If a flexible conduit is used, remove the strain bar and slide the conduit over the edges around the openings. H05VV-F (2x0.75) and H05VV-F (3x1.5) are only to be used with a 16 mm flexible conduit.

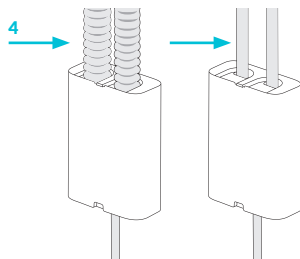



Step 5. Slide the sleeve over the driver to close it, then install the downlight in the intended location.

Follow the instructions in the app

Download the Plejd app on the App Store or Google Play. Use the app to complete the installation and group your downlights. Setup requires Bluetooth® and an internet connection.

Hand over the Plejd system

Once you have completed the installation, you will find the system code in the app. Write the code on the included sticker . Place the sticker in the distribution box and give the welcome folder  to the customer.