

Infinity

SLC
Developed by
The Light Group

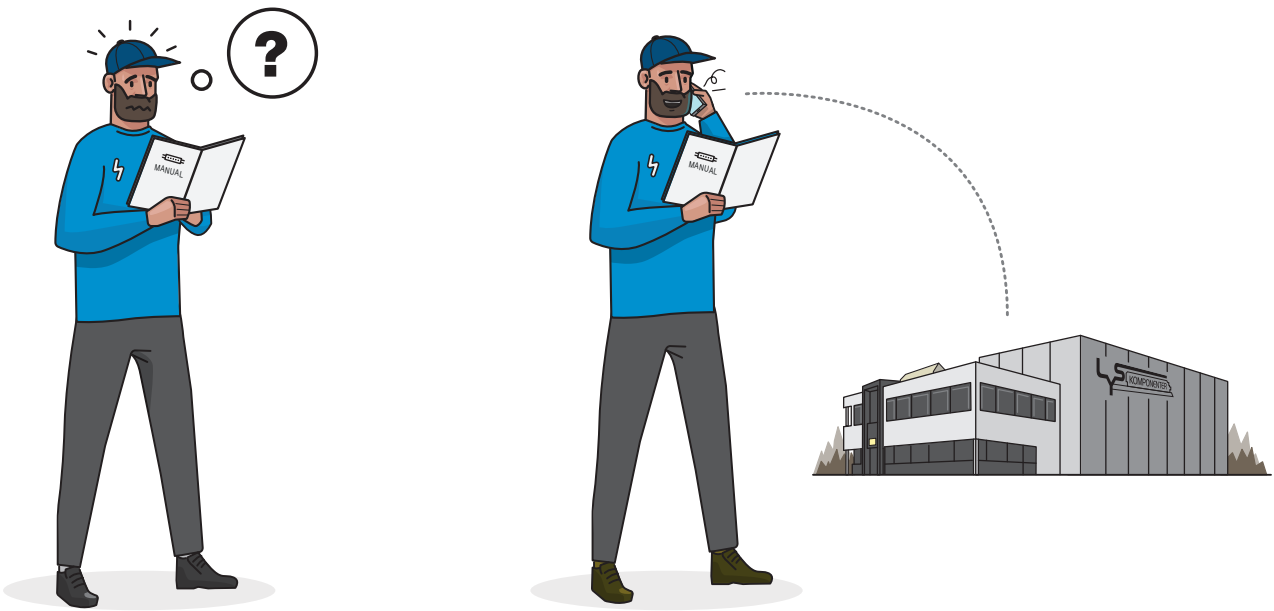

50m

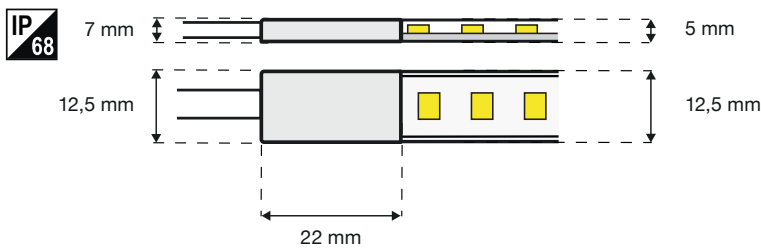
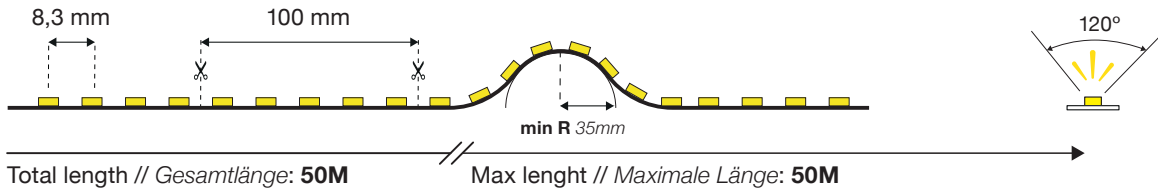

NO: Må installeres av godkjent installatør
EN: Only to be installed by an authorized electrician
DE: Nur von einer autorisierten Elektrofachkraft installierenlassen
FI: Asenna vain valtuutettu sähköasentaja
FR: Seulement pour être installé par un électricien autorisé
IS: Aðeins skal setja upp af viðurkenndum rafvirki
ES: Solo para ser instalado por un electricista autorizado.
IT: Solo per essere installato da un elettricista autorizzato
DK: Skal installeres af en godkendt installatør



NO: Slå av strømmen før montering
EN: Power off before installing
DE: Schalten Sie vor der Installation die Stromversorgung aus
FI: Katkaise virta ennen asennusta
FR: Couper le courant avant d'installer
IS: Slökktu á orku áður en þú setur upp
ES: Apague la alimentación antes de instalar
IT: Spegnerne l'alimentazione prima di installare
DK: Sluk for strømmen før installation.



Management, Operation
and Maintenance

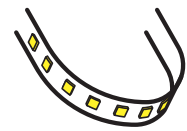
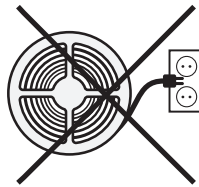
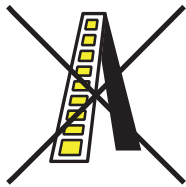
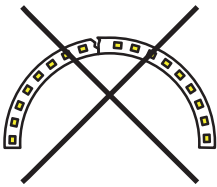

min R 35mm

Preparation

Feeder with 5 m cable S90190
Cutting kit S90181

Feeder kit Includes

1 x 5m cable
1 x Long end caps with a hole,

Cutting kit Includes

2 x Long end caps with a hole,
2 x Short end caps without a hole
1 x tube of glue
1 x glue plug

1

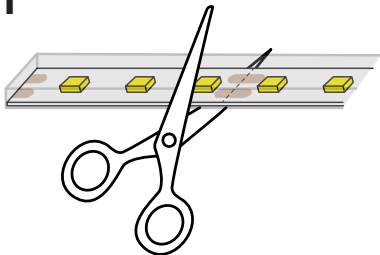

2

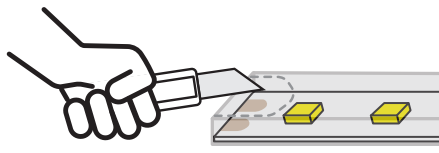

2

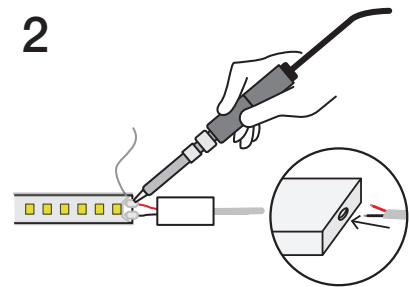

3

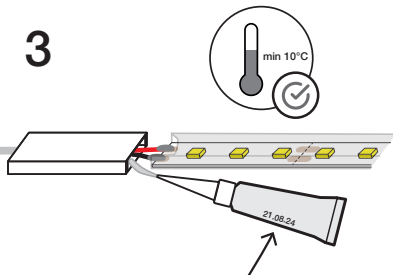

Warranty = Date + 6months

4



5

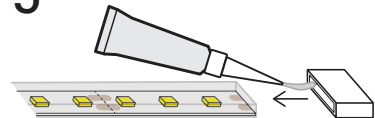

6

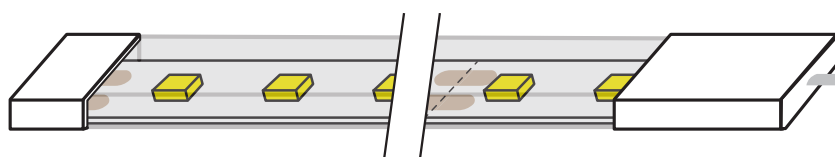

@ 25°C = 1 hr

@ 10°C = 3-4 hr

25mm

40mm

Installation

Sadle clips 50 pcs S15006

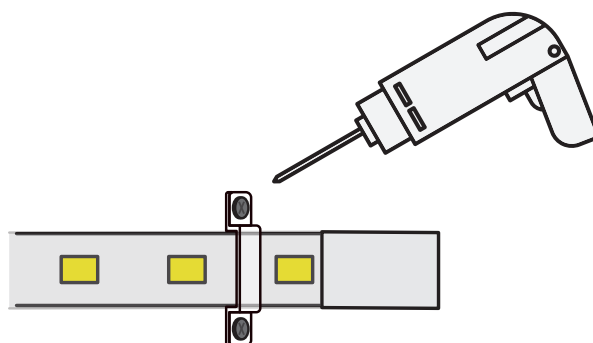
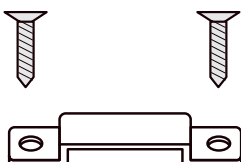

Installation

Profile S40142

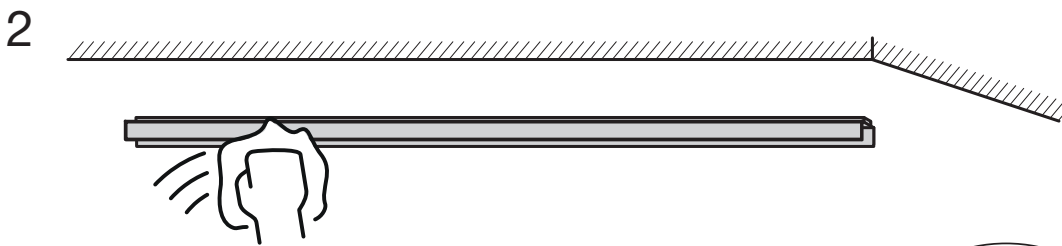
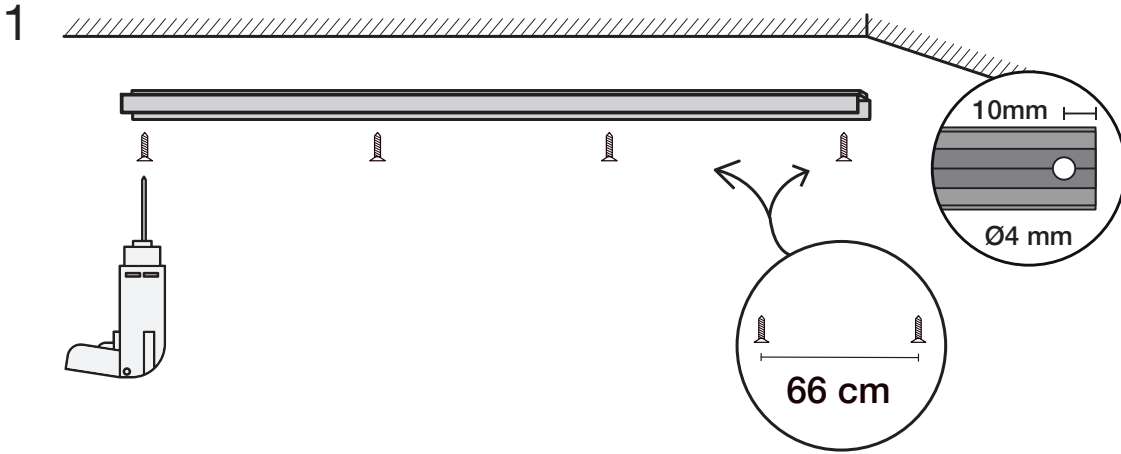
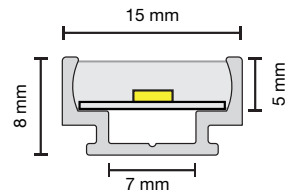
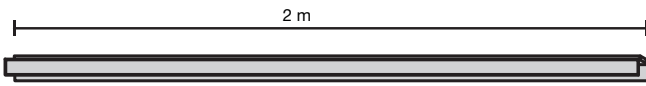

3 Measure the profile and adjust the LED strip to ensure it aligns with the cutting points. See the previous page for instructions.

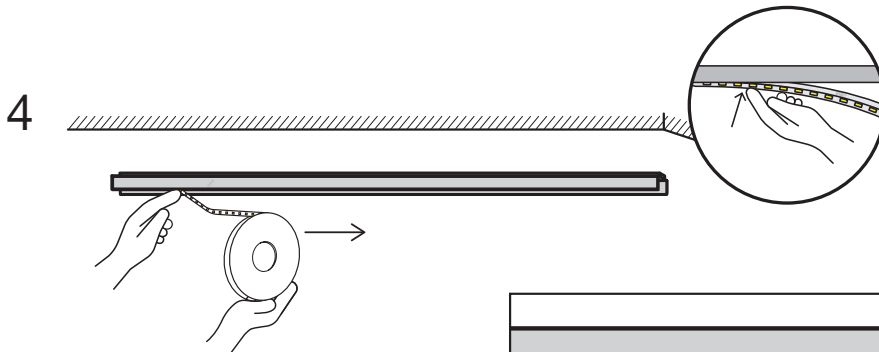
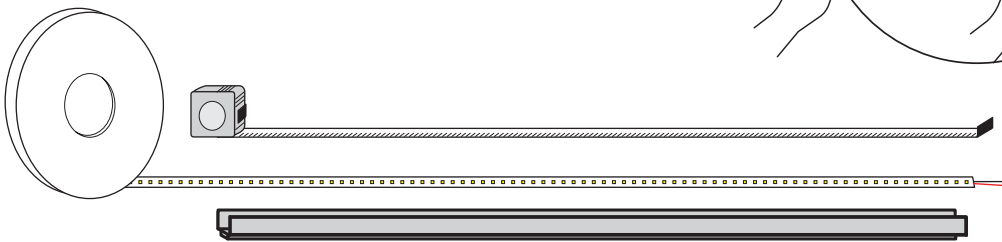
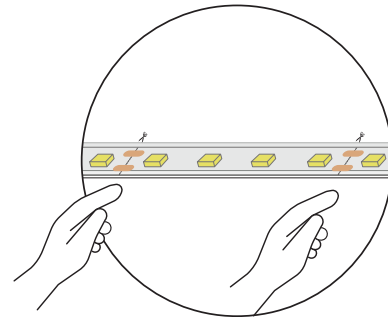

Press the LED strip firmly into the profile. The adhesive tape is not required for this installation.

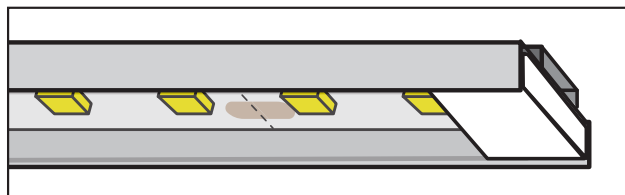

5 Connect the driver.
Non-Dim

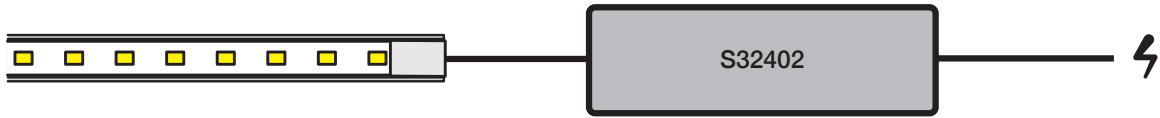

Trailing edge / PWM-dim

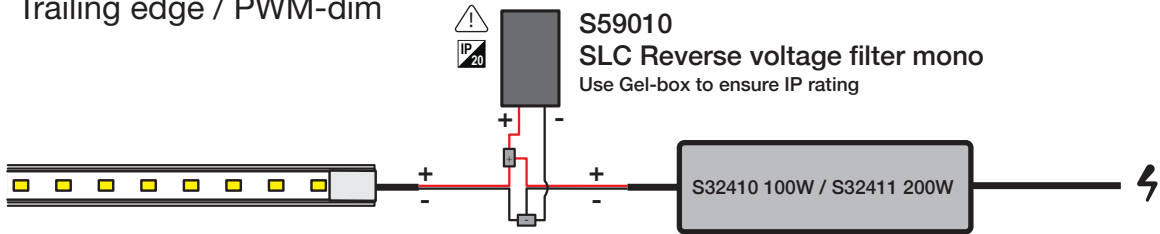

Warning: Reverse voltage filter required for dimming.
The SLC Controller S23003A has a built-in reverse voltage filter.
If using other controllers, make sure they have this, or use the SLC S59010 Reverse voltage filter. Without such filter, reverse voltage oscillation from PWM dimming can occur and damage the LED strip. The product warranty will be void.

DALI

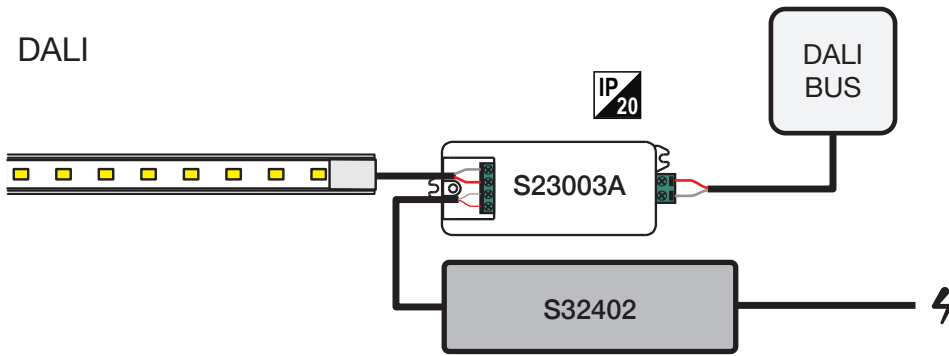

6 Always test the LED strips after installation to ensure everything is working as intended.

